

CTP:GT911

PIN#	Assignment
1	Shutdown
2	VCC (3.3v)
3	GND
4	INT
5	SDA
6	SCL

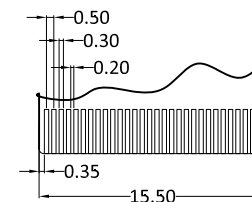
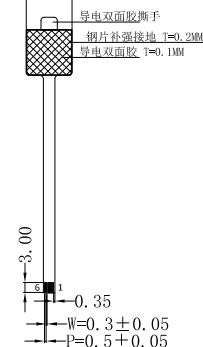

Notes:

1. LED CIRCUIT DIAGRAM:



Backlight LED Circuit
3*10=30LED, U=17.0-19.0V I=200mA

SPECIFICATIONS:

1. DISPLAY TYPE: 7.0"/ IPS / 1024*600
2. DRIVE IC: EK79007AD3
3. OPERATING TEMPERATURE: -20 ~ 60°C
4. STORAGE TEMPERATURE: -30 ~ 70°C
5. VIEWING ANGLE: IPS
6. BACKLIGHT: WHITE LED, VF=18V, IF=200mA
7. BRIGHTNESS: 800 CD/M2 (TYP)
8. CUSTOMER PART NO.: BOCEN STANDARD PRODUCT

No	PIN NAME
1	LED+
2	LED+
3	LCD_VGH
4	LCD_VGL
5	UPDN
6	SHLR
7	LED-
8	LED-
9	AVDD
10	GND
11	MIPI_TDP3
12	MIPI_TDN3
13	GND
14	MIPI_TDP2
15	MIPI_TDN2
16	GND
17	MIPI_TCP
18	MIPI_TCN
19	GND
20	MIPI_TDP1
21	MIPI_TDN1
22	GND
23	MIPI_TDP0
24	MIPI_TDN0
25	GND
26	STBYB
27	RSTB
28	VDD
29	VDD
30	VCOM

BOCEN DISPLAY TECHNOLOGY CO., LTD.

DESIGNED BY: Sylar

BF7030-08C

VERSION: 1.0

CHECKED BY: William

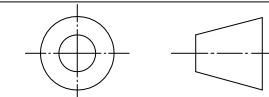

NO.: 1 OF 1

APPROVED BY: Rio

UNIT: mm

Website: <http://www.bocentech.com>

DATE: 2025-02-14