

Version

1.0 2019-05-25 New Issue

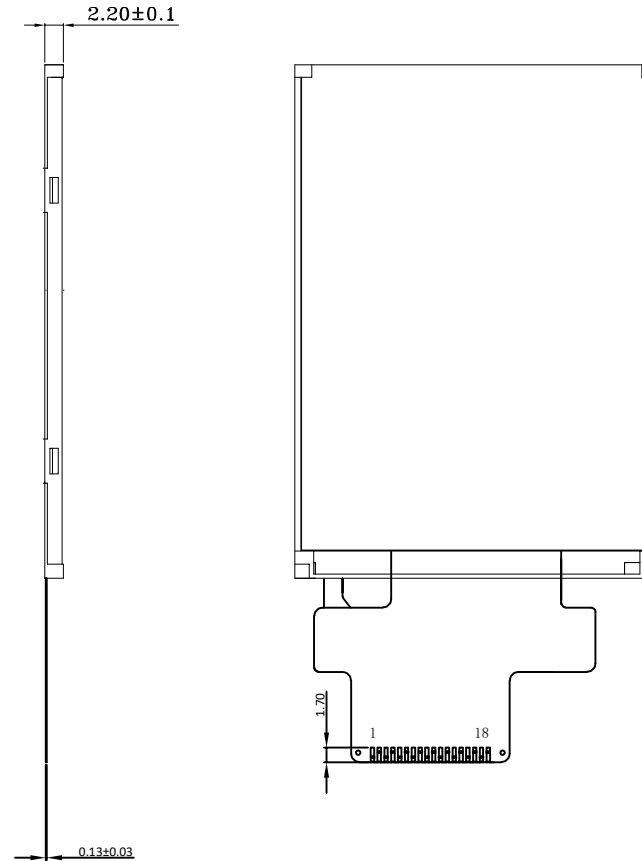
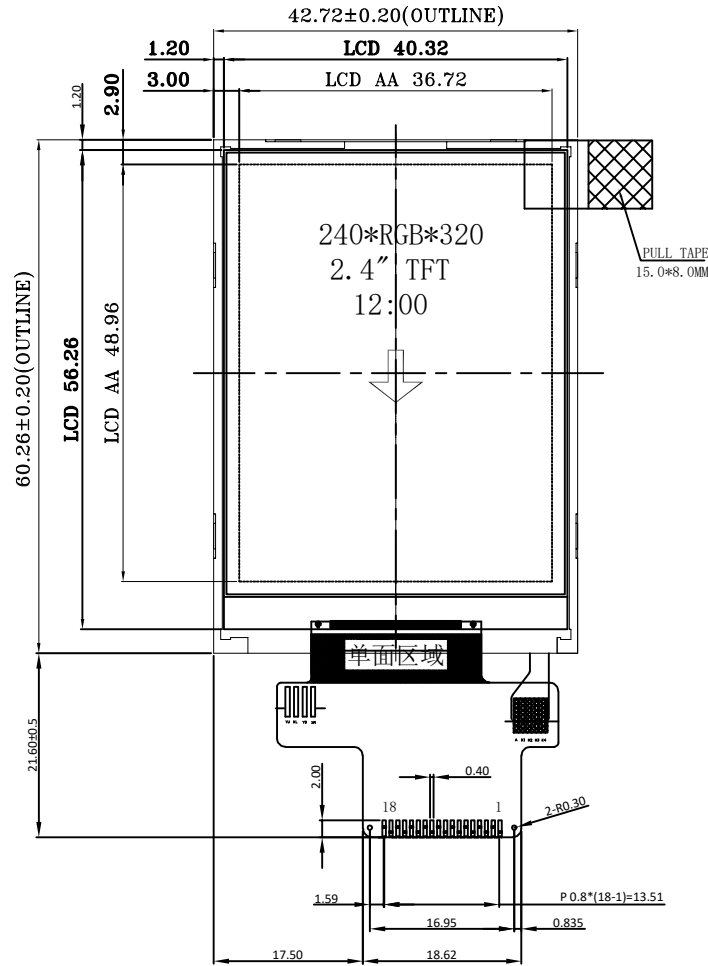

PIN	Symbol
1	GND
2	LEDK
3	LEDA
4	GND
5	RESET
6	A0
7	SDA
8	SCK
9	VCC(2.8V)
10	IOVCC(1.8V)
11	CS
12	GND
13	YD
14	XL
15	YU
16	XR
17	TE
18	GND

Backlight circuit (4 Series):

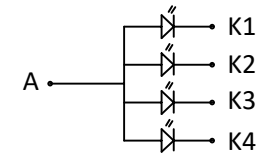

BL Drive VF=3.2V; If=20\*4mA

**SPECIFICATIONS:**

- |                           |                        |
|---------------------------|------------------------|
| 1. DISPLAY TYPE:          | 2.4" / TN / QVGA       |
| 2. DRIVE IC:              | ST7789V                |
| 3. OPERATING TEMPERATURE: | -20 ~ 70°C             |
| 4. STORAGE TEMPERATURE:   | -30 ~ 80°C             |
| 5. VIEWING ANGLE:         | 12 O'CLOCK             |
| 6. BACKLIGHT:             | 4-LED/Parallel/20mA    |
| 7. CUSTOMER PART NO.:     | BOCEN STANDARD PRODUCT |

**BOCEN DISPLAY TECHNOLOGY CO., LTD.**

DESIGNED BY: Shawn

**BF2418-01**

VERSION: 1.0

CHECKED BY: William

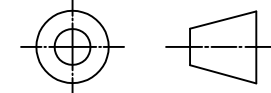

NO.: 1 OF 1

APPROVED BY: Rio

UNIT: mm

Website: <http://www.bocentech.com>

DATE: 2019-05-25