

PIN	SYMBOL
1	CSB
2	RSTB
3	A0
4	SCL
5	SDA
6	VDD
7	VSS
8	V0
9	XV0
10	VG
11	NC
12	LEDA
13	LEDKR
14	LEDKW

**SPECIFICATIONS:**

- |                           |  |
|---------------------------|--|
| 1. DISPLAY TYPE:          | FSTN / POSITIVE/ TRANSFLECTIVE               |
| 2. DRIVE IC:              | ST7567A                                      |
| 3. OPERATING VOLTAGE:     | Vlcd=9.0V; Vdd=3.0V                          |
| 4. OPERATING TEMPERATURE: | -20°C ~ +70°C                                |
| 5. STORAGE TEMPERATURE:   | -30°C ~+80°C                                 |
| 6. DRIVE MODE:            | 1/48DUTY, 1/8BIAS                            |
| 7. VIEWING ANGLE:         | 6 O'CLOCK                                    |
| 8. BACKLIGHT:             | 3PCS WHITE/RED LED IF=45mA/30mA,VF=3.0V/1.9V |
| 9. CUSTOMER PART NO.:     | BOCEN STANDARD PRODUCT                       |

**BOCEN DISPLAY TECHNOLOGY CO., LTD.**

DESIGNED BY: Shawn

**BG12848-15**

VERSION: 1.0

CHECKED BY: William

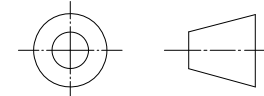

NO.: 1 OF 1

APPROVED BY: Rio

UNIT: mm

Website: <http://www.bocentech.com>

DATE: 2019-11-04