

PIN	SYMBOL
1	CS1
2	RES
3	A0
4	SCK
5	SDA
6	VDD
7	VSS
8	A
9	K

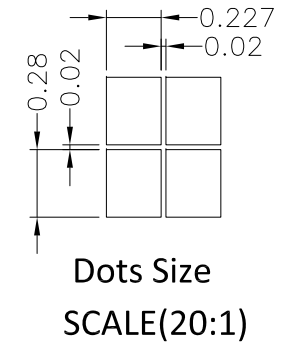

**SPECIFICATIONS:**

- |                           |                                |
|---------------------------|--------------------------------|
| 1. DISPLAY TYPE:          | FSTN / POSITIVE / TRANSMISSIVE |
| 2. DRIVE IC:              | ST7567A                        |
| 3. OPERATING VOLTAGE:     | Vlcd=6.5V; Vdd=3.3V            |
| 4. OPERATING TEMPERATURE: | -20°C ~ +70°C                  |
| 5. STORAGE TEMPERATURE:   | -30°C ~ +80°C                  |
| 6. DRIVE MODE:            | 1/33DUTY, 1/6BIAS              |
| 7. BACKLIGHT:             | WHITE, IF=15mA; VF=3.10V       |
| 8. VIEWING ANGLE:         | 12 O'CLOCK                     |
| 9. CUSTOMER PART NO.:     | BOCEN STANDARD PRODUCT         |

**BOCEN DISPLAY TECHNOLOGY CO., LTD.**

DESIGNED BY: Shawn

**BG12824-02**

VERSION: 1.0

CHECKED BY: William

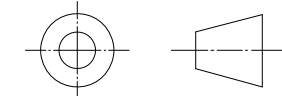

NO.: 1 OF 1

APPROVED BY: Rio

UNIT: mm

Website: <http://www.bocentech.com>

DATE: 2016-04-10