

PIN	SYMBOL	PIN	SYMBOL
1	CS	11	D5
2	RES	12	D6
3	A0	13	D7
4	WR	14	VDD
5	RD	15	VSS
6	D0	16	V0
7	D1	17	XV0
8	D2	18	VG
9	D3	19	C86
10	D4	20	PS

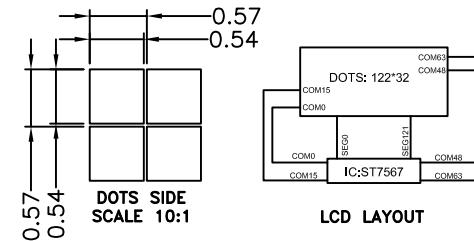

SPECIFICATIONS:

- | | |
|---------------------------|------------------------------|
| 1. DISPLAY TYPE: | FSTN / POSITIVE / REFLECTIVE |
| 2. DRIVE IC: | ST7567 |
| 3. OPERATING VOLTAGE: | Vop=8.0V; Vdd=3.3V |
| 4. OPERATING TEMPERATURE: | -20°C ~ +70°C |
| 5. STORAGE TEMPERATURE: | -30°C ~ +80°C |
| 6. DRIVE MODE: | 1/33DUTY, 1/6BIAS |
| 7. BACKLIGHT: | ----- |
| 8. VIEWING ANGLE: | 6 O'CLOCK |
| 9. CUSTOMER PART NO.: | BOCEN STANDARD PRODUCT |

BOCEN DISPLAY TECHNOLOGY CO., LTD.

DESIGNED BY: Shawn

BG12232-03

VERSION: 1.0

CHECKED BY: William

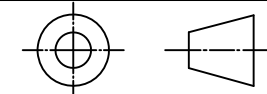

NO.: 1 OF 1

APPROVED BY: Rio

UNIT: mm

Website: <http://www.bocentech.com>

DATE: 2018-11-24