

SCALE: 20:1

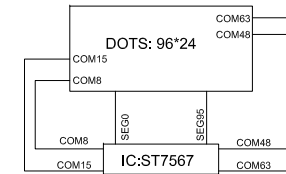

LCD LAYOUT

PIN	SYMBOL
1	VG
2	XV0
3	V0
4	VSS
5	VDD
6	SDA
7	SCL
8	A0
9	RESET
10	CS1B
11	LED-A
12	LED-K

SPECIFICATIONS:

- 1. DISPLAY TYPE: FSTN / NEGATIVE/ TRANSMISSIVE
- 2. DRIVE IC: ST7567
- 3. OPERATING VOLTAGE: Vop=7.8V; Vdd=3.3V
- 4. OPERATING TEMPERATURE: -20°C ~ +70°C
- 5. STORAGE TEMPERATURE: -30°C ~+80°C
- 6. DRIVE MODE: 1/33DUTY, 1/6BIAS
- 7. BACKLIGHT: 2PCS WHITE LEDS, IF=30mA, VF=3.0V
- 8. VIEWING ANGLE: 6 O'CLOCK
- 9. CUSTOMER PART NO.: BOCEN STANDARD PRODUCT

BOCEN DISPLAY TECHNOLOGY CO., LTD.

DESIGNED BY: Shawn

BG9624-02

VERSION: 1.0

CHECKED BY: William

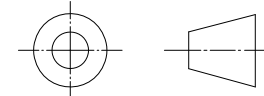

NO.: 1 OF 1

APPROVED BY: Rio

UNIT: mm

Website: <http://www.bocentech.com>

DATE: 2016-10-18