

PIN	SYMBOL
1	RES
2	SCL
3	SDA
4	VSS
5	VDD
6	CAP1+
7	CAP1-
8	VOUT

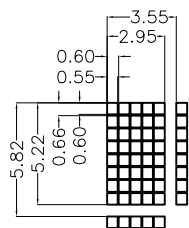

DOTS SIDE  
SCALE 2:1

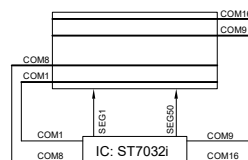

LCD LAYOUT

**SPECIFICATIONS:**

- 1. DISPLAY TYPE: FSTN / POSITIVE / TRANSFLECTIVE
- 2. DRIVE IC: ST70321-0D-G
- 3. OPERATING VOLTAGE: Vop=5.0V; Vdd=3.3V
- 4. OPERATING TEMPERATURE: -20°C ~ +70°C
- 5. STORAGE TEMPERATURE: -30°C ~+ 80°C
- 6. DRIVE MODE: 1/16 DUTY, 1/5 BIAS
- 7. VIEWING ANGLE: 6 O'CLOCK
- 8. BACKLIGHT: 1PCS WHITE LEDS
- 9. CUSTOMER PART NO.: BOCEN STANDARD PRODUCT

**BOCEN DISPLAY TECHNOLOGY CO., LTD.**

DESIGNED BY: Shawn

**BG1002-01**

VERSION: 1.0

CHECKED BY: William

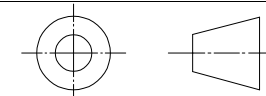

NO.: 1 OF 1

APPROVED BY: Rio

UNIT: mm

Website: <http://www.bocentech.com>

DATE: 2016-01-16