

Version

1.0 2023-07-18 New Issue

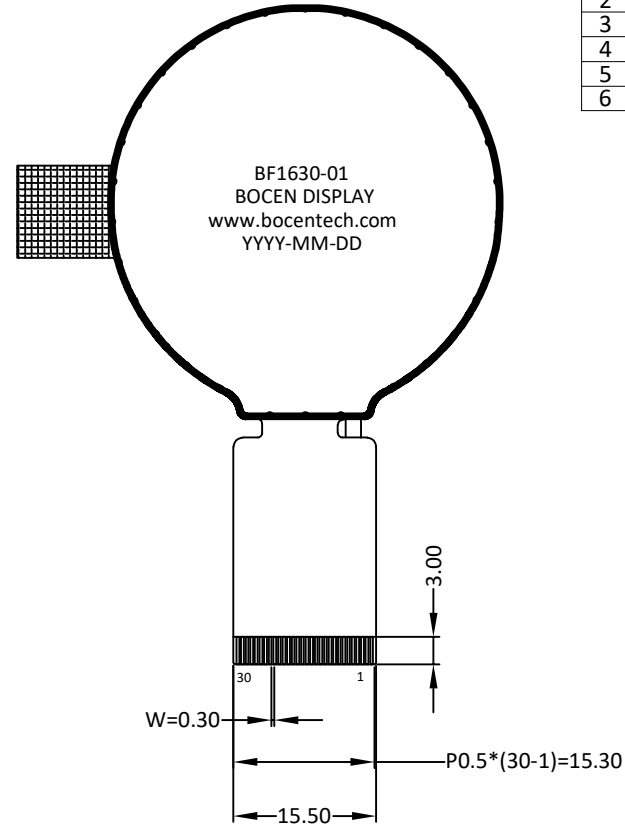
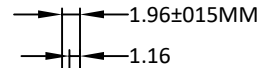
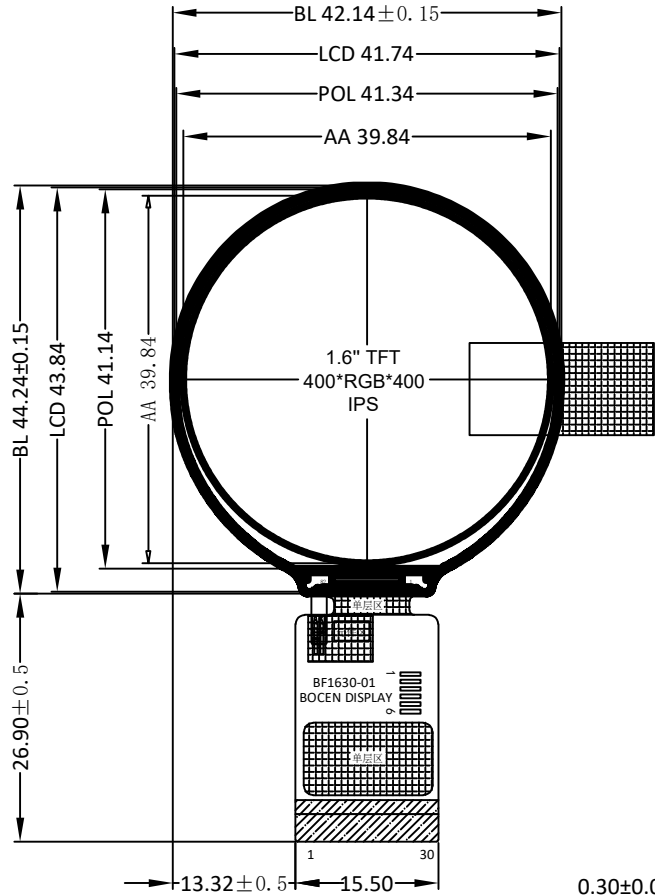

Touch Panel

PIN	SYMBOL
1	TP_RST
2	VDD
3	TP_INT
4	TP_SDA
5	TP_SCL
6	GND

TFT

PIN	SYMBOL
1	LEDA
2	LEDK
3	LEDK
4	VCI
5	IOVCC
6	RESET
7	TE
8	PWM
9	GND
10	DOP
11	DON
12	GND
13	D1P
14	D1N
15	GND
16	CLKP
17	CLKN
18	GND
19	NC
20	NC
21	GND
22	NC
23	NC
24	GND
25	TP_INT
26	TP_SDA
27	TP_SCL
28	TP_RESET
29	TP_VCI
30	NC

## SPECIFICATIONS:

- DISPLAY TYPE: 1.6" / 400\*400
- DRIVE IC: ST7797
- OPERATING TEMPERATURE: -20 ~ 70°C
- STORAGE TEMPERATURE: -30 ~ 80°C
- VIEWING ANGLE: IPS
- BACKLIGHT: 3 WHITE LED, 20mA
- CUSTOMER PART NO.: BOCEN STANDARD PRODUCT

BACKLIGHT CIRCUIT DIAGRAM

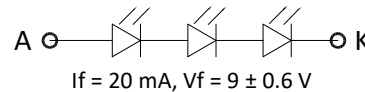

## BOCEN DISPLAY TECHNOLOGY CO., LTD.

DESIGNED BY: David

BF1630-01

VERSION: 1.0

CHECKED BY: William

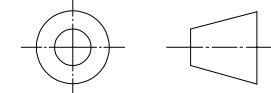

NO.: 1 OF 1

APPROVED BY: Rio

UNIT: mm

Website: <http://www.bocentech.com>

DATE: 2023-07-18