

※1.Internal Circuit Diagram

PIN	SYMBOL
1	LED+
2	LED+
3	LED+
4	NC
5	LED-
6	LED-
7	LED-
8	LED-
9	GND
10	GND
11	MIPI_2P
12	MIPI_2N
13	GND
14	MIPI_1P
15	MIPI_1N
16	GND
17	MIPI_CLKP
18	MIPI_CLKN
19	GND
20	MIPI_OP
21	MIPI_ON
22	GND
23	MIPI_3P
24	MIPI_3N
25	GND
26	NC
27	RESET
28	NC
29	VDDIO
30	VDD
31	VDD

SPECIFICATIONS:

- | | |
|---------------------------|---|
| 1. DISPLAY TYPE: | 8.0" / IPS / 800*1280 |
| 2. OPERATING TEMPERATURE: | -10 ~ 60°C |
| 3. STORAGE TEMPERATURE: | -20 ~ 70°C |
| 4. VIEWING ANGLE: | IPS |
| 5. POWER SUPPLY: | 3.3V |
| 6. INTERFACE: | MIPI 4LINE |
| 7. CONNECTOR: | FPC0310-31RL-TAG |
| 8. BACKLIGHT: | WLED(3S7P) 9.6V/140MA, 300CD/M ² |
| 9. CUSTOMER PART NO.: | BOCEN STANDARD PRODUCT |

BOCEN DISPLAY TECHNOLOGY CO., LTD.

DESIGNED BY: Shawn

BF8031-01

VERSION: 1.0

CHECKED BY: William

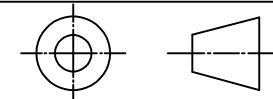

NO.: 1 OF 1

APPROVED BY: Rio

UNIT: mm

Website: <http://www.bocentech.com>

DATE: 2022-11-01