

PIN	SYMBOL
1	LEDK2
2	LEDK1
3	LEDA
4	LEDA
5	NC
6	GND
7	VDD-MTP
8	ROM-RLB
9	SDA
10	SCL
11	LR
12	UD
13	VCC
14	VCC
15	GND
16	DEN
17	HSYNC
18	VSYNC
19	GND
20	CLK
21	GND
22	B7
23	B6
24	B5
25	B4
26	B3
27	B2
28	B1
29	B0
30	GND
31	G7
32	G6
33	G5
34	G4
35	G3
36	G2
37	G1
38	G0
39	GND
40	R7
41	R6
42	R5
43	R4
44	R3
45	R2
46	R1
47	R0
48	GND
49	RESET
50	STBYB

### SPECIFICATIONS:

- |                           |                              |
|---------------------------|------------------------------|
| 1. DISPLAY TYPE:          | 5.0" TFT / IPS / 800*480     |
| 2. DRIVE IC:              | ST7265                       |
| 3. OPERATING TEMPERATURE: | -30 ~ 85°C                   |
| 4. STORAGE TEMPERATURE:   | -30 ~ 85°C                   |
| 5. BRIGHTNESS:            | 800 CD/M <sup>2</sup> (MIN.) |
| 6. BACKLIGHT:             | 14 WHITE LED                 |
| 7. CUSTOMER PART NO.:     | BOCEN STANDARD PRODUCT       |

### LED CIRCUIT DIAGRAM

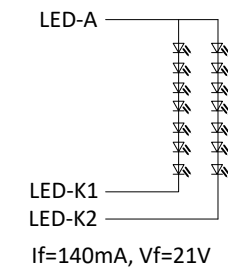

## BOCEN DISPLAY TECHNOLOGY CO., LTD.

DESIGNED BY: David

**BF5050-02**

VERSION: 1.0

CHECKED BY: William

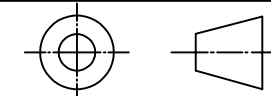

NO.: 1 OF 1

APPROVED BY: Rio

UNIT: mm

Website: <http://www.bocentech.com>

DATE: 2022-9-24