

Version

1.0

2021-9-8

New Issue

## TOP VIEW

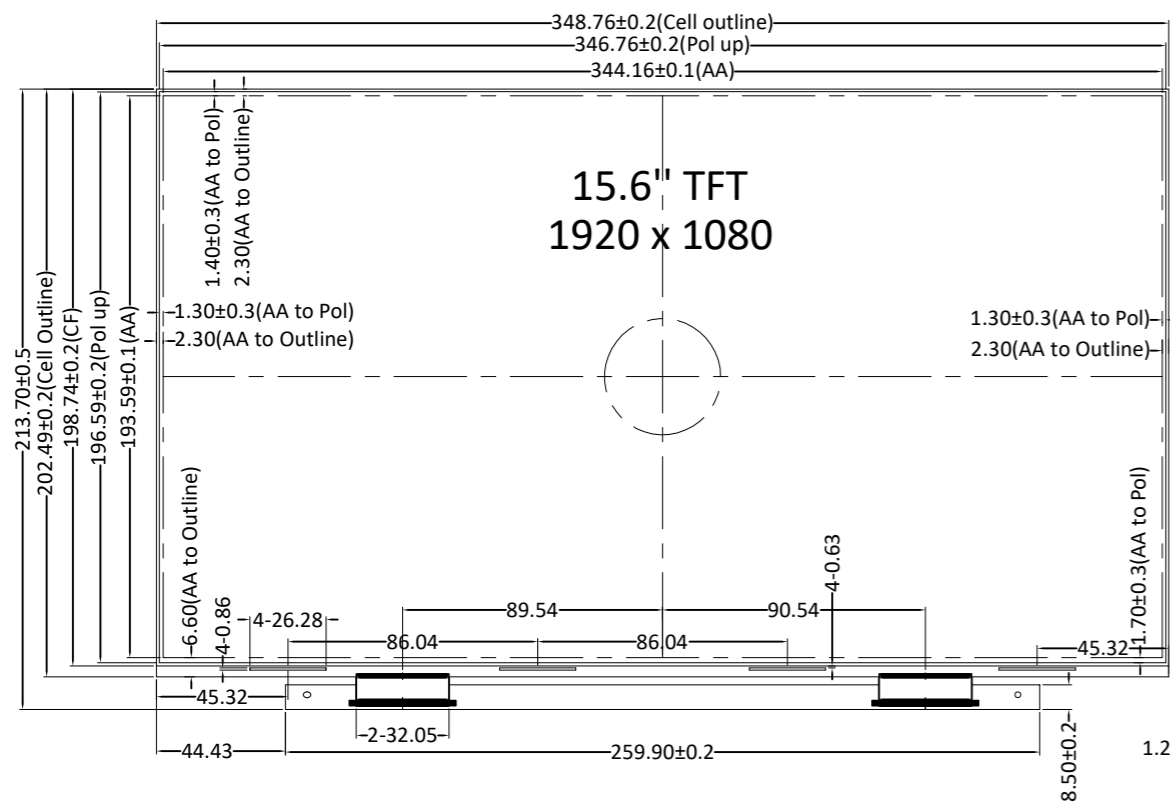

## SIDE VIEW



## BACK VIEW

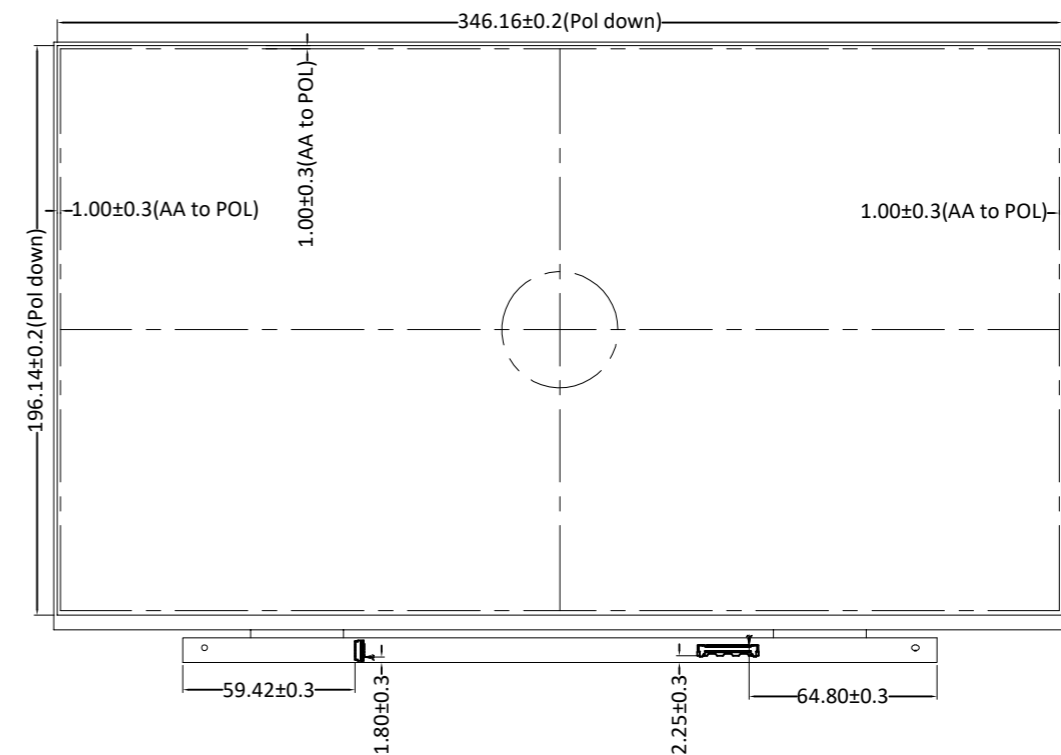

PIN	SYMBOL
1	NC
2	H-GND
3	LANE1-N
4	LANE1-P
5	H-GND
6	LANE0-N
7	LANE0-P
8	H-GND
9	AUX-CH-P
10	AUX-CH-N
11	H-GND
12	LCD-VCC
13	LCD-VCC
14	BIST
15	GND
16	GND
17	HPD
18	BL-GND
19	BL-GND
20	BL-GND
21	BL-GND
22	BL-ENABLE
23	BL-PWM
24	NC
25	NC
26	BL-POWER
27	BL-POWER
28	BL-POWER
29	BL-POWER
30	NC

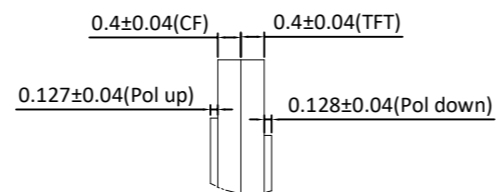

Detail A

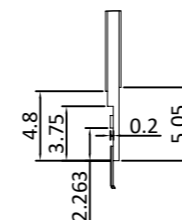

Detail B

## SPECIFICATIONS:

- DISPLAY TYPE: 15.6"/ 1920\*1080
- OPERATING TEMPERATURE: 0 ~ 50°C
- STORAGE TEMPERATURE: -20 ~ 60°C
- VIEWING ANGLE: IPS
- TOLERANCE NOT STATED: ±0.5 MM
-  COPPER AREA: CONNECT GND
- CUSTOMER PART NO.: BOCEN STANDARD PRODUCT

## BOCEN DISPLAY TECHNOLOGY CO., LTD.

DESIGNED BY: Shawn

BF15630-01

VERSION: 1.0

CHECKED BY: William

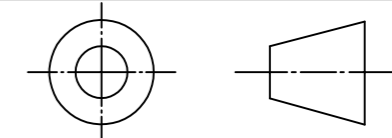

NO.: 1 OF 1

APPROVED BY: Rio

UNIT: mm

Website: <http://www.bocentech.com>

DATE: 2021-9-8