

PIN	SYMBOL
1	VLCD
2	VB0-
3	VB1-
4	VB1+
5	VB0+
6	VDD
7	VSS
8	POR
9	BMO
10	CS0
11	CD
12	RSTB
13	SCK(D0)
14	SDA
15	D7
16	ITO-VSS

SPECIFICATIONS:

- | | |
|---------------------------|----------------------------------|
| 1. DISPLAY TYPE: | FSTN / POSITIVE/ TRANSMISSIVE |
| 2. DRIVE IC: | UC1609C |
| 3. OPERATING VOLTAGE: | Vop=10V; Vdd=3V |
| 4. OPERATING TEMPERATURE: | -20°C ~ +70°C |
| 5. STORAGE TEMPERATURE: | -30°C ~+80°C |
| 6. DRIVE MODE: | 1/64DUTY, 1/9BIAS |
| 7. VIEWING ANGLE: | 6 O'CLOCK |
| 8. BACKLIGHT: | 5PCS white LED; IF=75mA; VF=3.3V |
| 9. CUSTOMER PART NO.: | BOCEN STANDARD PRODUCT |

BOCEN DISPLAY TECHNOLOGY CO., LTD.

DESIGNED BY: Shawn

BG19264-02

VERSION: 1.0

CHECKED BY: William

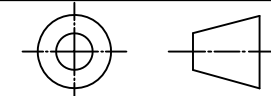

NO.: 1 OF 3

APPROVED BY: Rio

UNIT: mm

Website: <http://www.bocentech.com>

DATE: 2015-05-12