

Revised Record

1.0 2011-6-29 New Issue

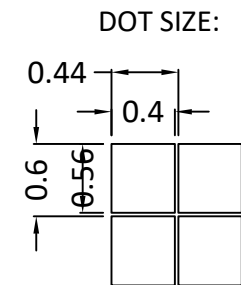
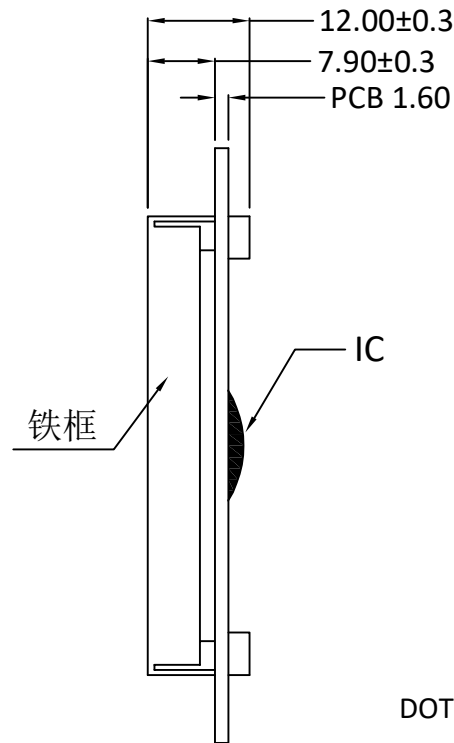
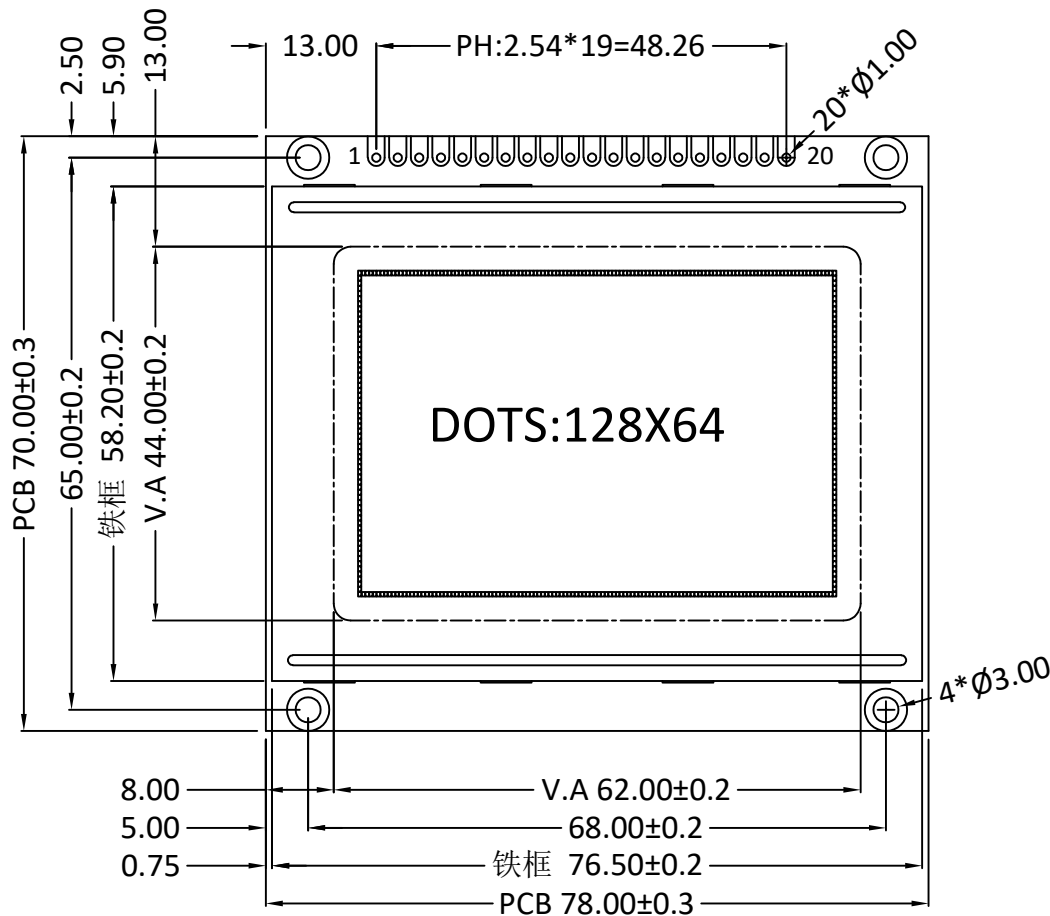

PIN	SYMBOL
1	CS1
2	CS2
3	VSS
4	VDD(5V)
5	V0
6	RS
7	R/W
8	E
9	DB0
10	DB1
11	DB2
12	DB3
13	DB4
14	DB5
15	DB6
16	DB7
17	RST
18	VOUT
19	LED-A(5V)
20	LED-K

SPECIFICATIONS:

1. DISPLAY TYPE: STN / NEGATIVE (BLUE) / TRANSMISSIVE
2. DRIVE IC: AIP31107, AIP31108 or EQV.
3. CONNECTOR: ZEBRA
4. OPERATING VOLTAGE: VOP = 9.0 V, VDD = 5.0V
5. OPERATING TEMPERATURE: -20 ~ 70°C
6. STORAGE TEMPERATURE: -30 ~ 80°C
7. DRIVE MODE: 1/64 DUTY, 1/9 BIAS
8. VIEWING ANGLE: 6 O'CLOCK
9. BACKLIGHT: WHITE LED, I = 80mA
10. CUSTOMER PART NO.: BOCEN STANDARD PRODUCT

BOCEN DISPLAY TECHNOLOGY CO., LTD.

DESIGNED BY: Shawn

BB12864-03

VERSION: 1.0

CHECKED BY: William

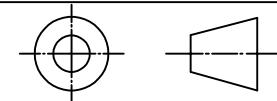

NO.: 1 OF 1

APPROVED BY: Rio

UNIT: mm

Website: <http://www.bocentech.com>

DATE: 2011-6-29