

PIN	SYMBOL
1	VBL-
2	VBL+
3	GND
4	VCC
5	R0
6	R1
7	R2
8	R3
9	R4
10	R5
11	R6
12	R7
13	G0
14	G1
15	G2
16	G3
17	G4
18	G5
19	G6
20	G7
21	B0
22	B1
23	B2
24	B3
25	B4
26	B5
27	B6
28	B7
29	GND
30	DCLK
31	DISP
32	HSYNC
33	VSYNC
34	DE
35	TP-INT
36	TP-SDA
37	TP-SCL
38	TP-RST
39	TP-VDD3V3
40	TP-GND

SPECIFICATIONS:

- | | |
|---------------------------|------------------------|
| 1. DISPLAY TYPE: | 5.0"/ IPS / 800*480 |
| 2. DRIVE IC: | ST7262 |
| 3. OPERATING TEMPERATURE: | -20 ~ 70°C |
| 4. STORAGE TEMPERATURE: | -30 ~ 80°C |
| 5. VIEWING ANGLE: | ALL |
| 6. BACKLIGHT: | 12 PCS WHITE LED |
| 7. BRIGHTNESS: | 260 CD/M2 (TYP) |
| 8. CUSTOMER PART NO.: | BOCEN STANDARD PRODUCT |

Backlight Circuit Diagram

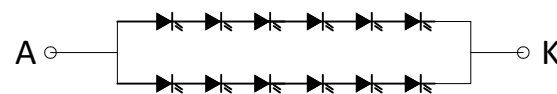

BOCEN DISPLAY TECHNOLOGY CO., LTD.

DESIGNED BY: Shawn

BF5040-04

VERSION: 1.0

CHECKED BY: William

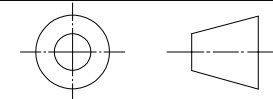

NO.: 1 OF 1

APPROVED BY: Rio

UNIT: mm

Website: <http://www.bocentech.com>

DATE: 2022-5-14