

PIN	SYMBOL
1	GND
2	ID
3	RST
4	LPTE
5	GND
6	VDDIO(1.8V)
7	VCC(2.8V)
8	GND
9	MIPI_DATANO
10	MIPI_DATAPO
11	GND
12	MIPI_CLKN
13	MIPI_CLKP
14	GND
15	LED-A
16	LED-K

SPECIFICATIONS:

- | | |
|---------------------------|-------------------------|
| 1. DISPLAY TYPE: | 3.5" TFT / TN / 320*480 |
| 2. DRIVE IC: | ILI9488 |
| 3. OPERATING TEMPERATURE: | -20 ~ 70°C |
| 4. STORAGE TEMPERATURE: | -30 ~ 80°C |
| 5. VIEWING ANGLE: | 12 O'CLOCK |
| 6. BACKLIGHT: | 6-LED / 40mA |
| 7. CUSTOMER PART NO.: | BOCEN STANDARD PRODUCT |

LED CIRCUIT DIAGRAM

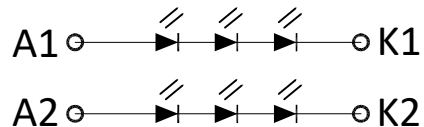

BOCEN DISPLAY TECHNOLOGY CO., LTD.

DESIGNED BY: Shawn

BF3516-01

VERSION: 1.0

CHECKED BY: William

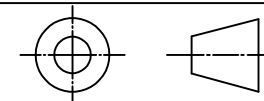

NO.: 1 OF 1

APPROVED BY: Rio

UNIT: mm

Website: <http://www.bocentech.com>

DATE: 2021-7-1