

BACKLIGHT CIRCUIT DIAGRAM

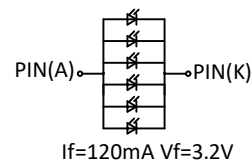

MIPI-2L

NO.	PIN NAME
1	LED+
2	LED-
3	AVDD_2V85
4	VDDIO_1V8
5	NC
6	GND
7	ID1
8	ID2
9	ID3
10	NC
11	GND
12	TE
13	RST-N
14	GND
15	GND
16	LANEO-P
17	LANEO-N
18	GND
19	LANE1-P
20	LANE1-N
21	GND
22	GND
23	CLK-P
24	CLK-N
25	GND

SPECIFICATIONS:

- | | |
|---------------------------|--------------------------|
| 1. DISPLAY TYPE: | 3.2" / TN / QVGA 240*320 |
| 2. DRIVE IC: | ST7785M |
| 3. OPERATING TEMPERATURE: | -20 ~ 70°C |
| 4. STORAGE TEMPERATURE: | -30 ~ 80°C |
| 5. VIEWING ANGLE: | 9:00 |
| 6. BACKLIGHT: | 6-LED / 3.2V / 120mA |
| 7. BRIGHTNESS: | 350(MIN), 400(TYP) |
| 8. CUSTOMER PART NO.: | BOCEN STANDARD PRODUCT |

BOCEN DISPLAY TECHNOLOGY CO., LTD.

DESIGNED BY: Shawn

BF3225-01

VERSION: 1.0

CHECKED BY: William

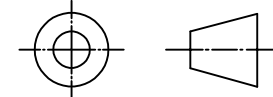

NO.: 1 OF 1

APPROVED BY: Rio

UNIT: mm

Website: <http://www.bocentech.com>

DATE: 2022-03-14