

PIN	SYMBOL
1	GND
2	D0P
3	D0N
4	GND
5	D1P
6	D1N
7	GND
8	CLKP
9	CLKN
10	GND
11	D2P
12	D2N
13	GND
14	D3P
15	D3N
16	GND
17	GND
18	IOVCC 1.8V
19	IOVCC 1.8V
20	NC
21	NC
22	NC
23	NC
24	RESET
25	NC
26	NC
27	GND
28	LEDK
29	LEDK
30	GND
31	NC
32	GND
33	GND
34	NC
35	LEDA
36	LEDA
37	GND
38	VCI 3.3V
39	VCI 3.3V
40	NC

SPECIFICATIONS:

- | | |
|---------------------------|--------------------------------|
| 1. DISPLAY TYPE: | 10.1" / 440*1920 |
| 2. DRIVER IC: | ILI9881C |
| 3. OPERATING TEMPERATURE: | -10 ~ 60°C |
| 4. STORAGE TEMPERATURE: | -20 ~ 70°C |
| 5. VIEWING ANGLE: | ALL |
| 6. BACKLIGHT: | 16 LED, Vf = 24±2.4V, If=100mA |
| 7. CUSTOMER PART NO.: | BOCEN STANDARD PRODUCT |

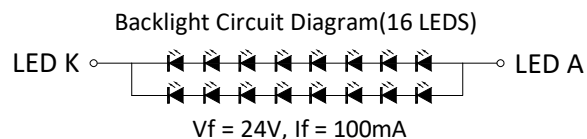

BOCEN DISPLAY TECHNOLOGY CO., LTD.

DESIGNED BY: Shawn

BF10140-03

VERSION: 1.0

CHECKED BY: William

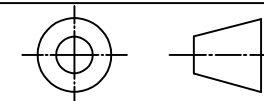

NO.: 1 OF 1

APPROVED BY: Rio

UNIT: mm

Website: <http://www.bocentech.com>

DATE: 2021-12-20