

TP SYMBOL

PIN	SYMBOL
1	VDD
2	GND
3	SCL
4	SDA
5	INT
6	RST

SPECIFICATIONS:

- | | |
|---------------------------|-------------|
| 1. DISPLAY TYPE: | 4.3" |
| 2. DRIVE IC: | FT5446U |
| 3. OPERATING TEMPERATURE: | -20 ~ 70°C |
| 4. STORAGE TEMPERATURE: | -30 ~ 80°C |
| 5. OPERATING VOLTAGE: | 2.8-3.3V |
| 6. COVER LENS: | 0.55MM |
| 7. PFC: | PITCH=0.5MM |
| 8. TOTAL THICKNESS: | 1.3±0.15MM |

BOCEN DISPLAY TECHNOLOGY CO., LTD.

DESIGNED BY: Finn

BF4340-06C

VERSION: 1.0

CHECKED BY: William

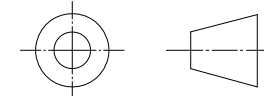

NO.: 1 OF 1

APPROVED BY: Shawn

UNIT: mm

Website: <http://www.bocentech.com>

DATE: 2022-3-24