

INTERFACE	
1	VSS
2	VDD(5V)
3	V0
4	RS
5	RW
6	E
7	DB0
8	DB1
9	DB2
10	DB3
11	DB4
12	DB5
13	DB6
14	DB7
15	LED-A(5V)
16	LED-K

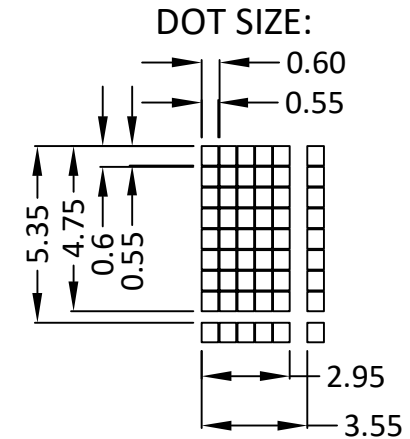

SPECIFICATIONS:

- | | |
|---------------------------|--------------------------------------|
| 1. DISPLAY TYPE: | STN / NEGATIVE (BLUE) / TRANSMISSIVE |
| 2. DRIVE IC: | SPLC780 or EQV. |
| 3. CONNECTOR: | ZEBRA |
| 4. OPERATING VOLTAGE: | VOP = 4.8 V, VDD = 5.0V |
| 5. OPERATING TEMPERATURE: | -20 ~ 70°C |
| 6. STORAGE TEMPERATURE: | -30 ~ 80°C |
| 7. DRIVE MODE: | 1/16 DUTY, 1/5 BIAS |
| 8. VIEWING ANGLE: | 6 O'CLOCK |
| 9. BACKLIGHT: | WHITE LED, I = 40mA |
| 10. CUSTOMER PART NO.: | BOCEN STANDARD PRODUCT |

BOCEN DISPLAY TECHNOLOGY CO., LTD.

DESIGNED BY: Shawn

BB1604-02

VERSION: 1.0

CHECKED BY: William

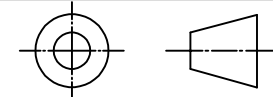

NO.: 1 OF 1

APPROVED BY: Rio

UNIT: mm

Website: <http://www.bocentech.com>

DATE: 2011-8-29